



Woods House, 7 Gatliff Road
London SW1W

GARTONJONES.COM



Woods House, 7 Gatliff Road London, SW1W

£625 Per Week

GARTON JONES.COM

8 Gatliff Road
Grosvenor
Waterside
Chelsea
London
SW1W 8DP

Sales +44 (0) 20 7730 5007
gws@gartonjones.com
www.gartonjones.com

A bright and airy ONE DOUBLE BEDROOM apartment to RENT of approx. 488 sq.ft (45sq.m) in Woods House, part of the popular Grosvenor Waterside development in Chelsea. This FURNISHED apartment has an open plan reception room with access to a PRIVATE DECKED TERRACE. There is a newly fitted kitchen with granite work surfaces, hob, oven and extractor fan and an integrated dishwasher and washer/dryer and a freestanding fridge/freezer. The modern bathroom has also recently been re-decorated and there is good storage to the bedroom. There is a 24 hour concierge, an on-site Sainsbury's Local, coffee shop, crèche and Purple Dragon private kids club. The additional amenities including shops, restaurants and the excellent transport links of both Sloane Square and Victoria are within walking distance.

Available via Garton Jones' on-site office at Grosvenor Waterside (underneath Bramah House).

Council Tax: Westminster City Council (band D)

EPC Rating: B (82)

12 month minimum term. 5 week deposit required.

Please note hot water and heating is included in the rent.

To check broadband and mobile phone coverage, please visit Ofcom: ofcom.org.uk/phones-telecoms-and-internet/advice-for-consumers/advice/ofcom-checker

- 488 Sq.ft (45.3 Sq.m)
- 1 Double Bedroom
- Modern Bathroom
- Open Plan Reception Room
- Newly Fitted Kitchen
- 24 Hour Concierge
- Private Decked Terrace Leading To Communal Garden
- On-Site Sainsbury's, Creche, Coffee Shop & Purple Dragon Private Kids' Club
- Within Walking Distance Of Victoria Train Station & Sloane Square
- On-Site Residents' Gym & Spa Facilities (Payable)



EPC certificate available on request.

Woods House

Approximate Gross Internal Area = 488 sq ft / 45.3 sq m

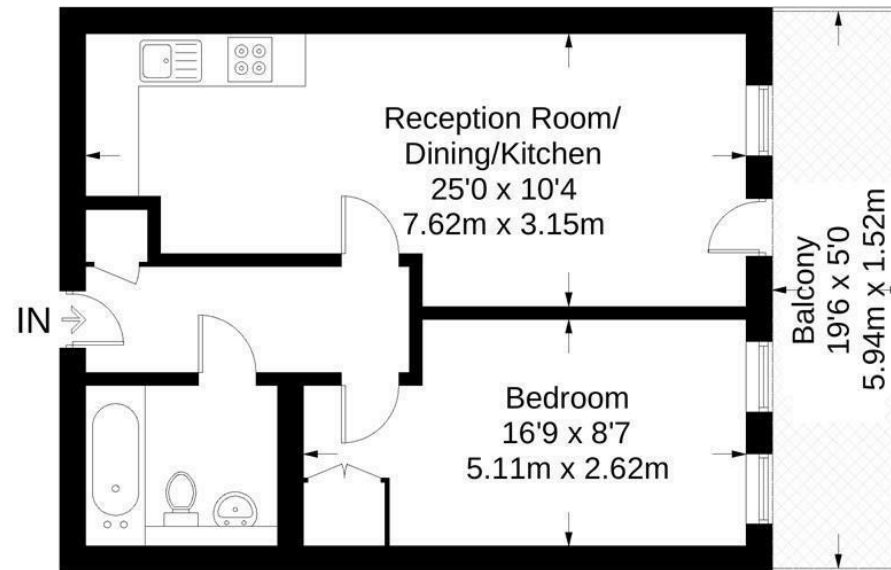

Not to scale, for guidance only and must not be relied upon as a statement of fact.
All measurements and areas are approximate only and have been prepared in
accordance with the current edition of the RICS Code of Measuring Practice.

